

LP Gas Hose Reels

| Home Delivery Trucks | Dispensing Systems | Fueling Vehicles |
| Filling Stationary and Portable Cylinders |



**You Can't Buy
A Better Reel.**

Family owned and operated since 1933

Series **PB/DPB**

To handle single 1" through 1-1/2" I.D. hose.

- Standard hose reel is steel construction, painted graphite. Aluminum or stainless steel construction is available.
- "SB" prefix denotes polished aluminum construction, offering both reduced weight and superior corrosion resistance compared to standard steel construction.
- Series PB are explosion-proof reels.
- Series DPB reel is direct hydraulic drive, eliminating the use of chain and sprockets.
- Choose gear-driven crank rewind, #40 chain and sprocket drive powered by an electric, hydraulic or compressed air motor or direct drive hydraulic rewind motor.
- Crank rewind reels and direct drive reels supplied with pinion brake.
- Power rewind reels (chain and sprocket driven) supplied with a strap brake. Other brake and locking devices may be specified.
- Standard inlet: 90° ball bearing swivel joint, 1-1/2" female NPT threads.
- Standard outlet: flanged riser, 1" female NPT threads. Standard inlet, outlet riser, and hub assembly are steel.
- Other sizes and/or threads can be furnished and must be specified.
- Pressures to 350 psi (24 bar).
- Temperatures from -40°F to +350°F (-40°C to +177°C).
- Consult factory for other pressures and temperatures.
- Chain guard available upon request, must be specified.
- Rollers and roller mounting brackets are accessory items. Specify roller position.



Series PB
Electric rewind shown



Series DPB
Direct drive hydraulic rewind shown
with optional Assembly C rollers

Series PB/DPB

PARTS DRAWING: ALUM. CONST. PRESSED FRAME – ISO 202; ALUM. SQUARE TUBE FRAME – ISO 204; STEEL CONST. PRESSED FRAME – ISO 18

Model Number For Power Rewind see Note 4	Hose Capacity of Reel feet m			Approx. Weight Power Rewind lb. kg				Reel Dimensions*** in. mm										
	I.D. in. mm	1 25	1-1/2 38	Steel		Alum.		A	B	C	D	E	F POWER	F DIRECT DRIVE HYD	G	H	X	Y
	O.D. in. mm	1.5 38	2.16 55	NET	SHIP	NET	SHIP											
PB24-23-24	125	–	142	184	119	160	21	15.5	10.5	20.5	22.75	29.25	35.12	23.5	12.12	13	16.75	
	38	–	64	83	54	72	533	394	267	521	578	743	892	597	308	330	425	
PB30-23-24	150	–	155	197	124	165	27.5	22	10.5	20.5	22.75	35.75	41.62	23.5	12.12	19.5	16.75	
	46	–	70	89	56	75	699	559	267	521	578	908	1057	597	308	495	425	
PB26-25-26	150	–	155	197	137	178	23	17.5	10.5	25.5	24.75	31	37	27.88	15.5	15	21.75	
	46	–	70	89	62	81	584	445	267	648	629	787	940	708	394	381	552	
PB28-25-26	200	–	163	205	157	198	25.5	20	10.5	25.5	24.75	33.75	39.62	27.88	15.5	17.5	21.75	
	61	–	74	93	71	90	648	508	267	648	629	857	1006	708	394	445	552	
PB22-30-31	250	–	158	208	130	175	19	13.5	10.5	25.5	28.75	27.25	33.12	29.88	15.5	11	21.75	
	76	–	71	94	59	79	483	343	267	648	730	692	841	759	394	279	552	
PB18-33-34	200	–	157	207	146	194	14.5	9.5	10.5	31.5	31.75	23.75	29.12	33.62	17.75	7	27.75	
	61	–	71	94	66	89	368	241	267	800	806	603	740	854	451	178	705	
PB24-25-26-15.5	–	50	160	202	133	174	21	15.5	15.5	25.5	24.75	29.25	–	27.88	15.5	13	21.75	
	–	15	64	91	60	79	533	394	394	648	629	743	–	708	394	330	552	
PB28-25-26-15.5	–	75	173	215	159	200	25.5	20	15.5	25.5	24.75	33.75	–	27.88	15.5	17.5	21.75	
	–	23	78	97	72	91	648	508	394	648	629	857	–	708	394	445	552	
PB26-30-31-15.5	–	100	173	215	140	185	23	17.5	15.5	25.5	28.75	31.25	–	29.88	15.5	15	21.75	
	–	30	78	97	63	84	584	445	394	648	730	794	–	759	394	381	552	

Notes:

- Specifications subject to change.
- Upon request, reels can be supplied with drum lengths other than shown and with disc sizes in other diameters.
- Dimensions shown for reels up to and including 30-31 disc size reflect pressed frames. Reel sizes ending in (33-34) are built with rollform/square tubing construction.
- When ordering power rewind models, prefix model number with:
 - A** = Air Rewind–Supplied with control valve and 25" air hose.
 - E** = Explosion-Proof Electric Rewind (2/3 HP)– Supplied with explosion-proof switch, solenoid, and junction box.
 - HD** = Hydraulic Rewind–Not supplied with control valve.
 - D** = Direct Drive Hydraulic Rewind–Not supplied with control valve.
 (When ordering **A**, **HD** & **D** power rewind reels deduct 20 lbs. from ship weight).

5. Be sure to check dimensions and weights prior to ordering.

NOTICE: A flexible connector must be used between the inlet pipe and the inlet swivel joint.

***X, Y indicate mounting holes.

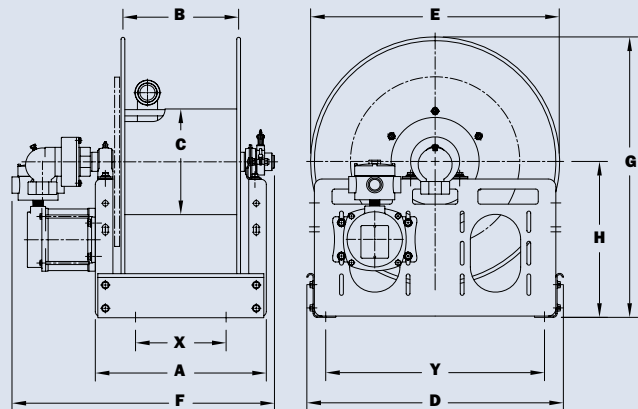

Series EPB

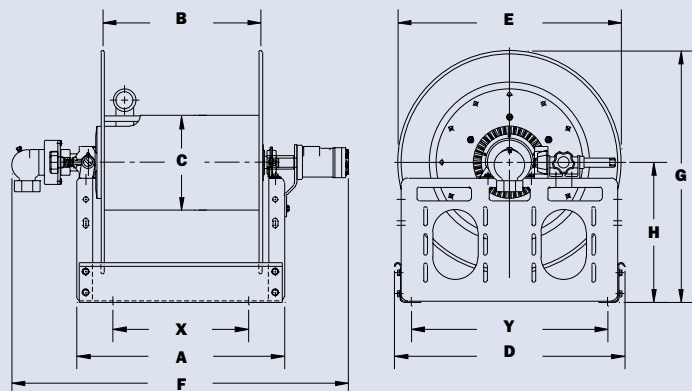

Series DPB

You Can't Buy A Better Reel.

Find reels for every need.

Learn more about all of our reels, including specs, drawings, and even how to select the right reels and accessories for your industry.



Ordering & Accessory Guide

Learn more about:

- Selecting the right reel
- Reel components
- Available accessories
- How to spec and order reels and accessories
- Ordering options
- Hannay Reels policies

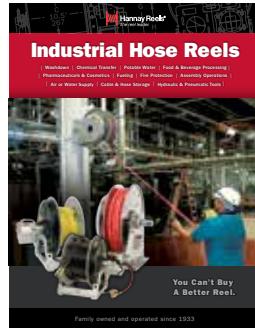

Industrial Hose Reels

Includes specs and information on:

- High pressure spring rewind reels
- Compact manual rewind reels
- Power rewind reels
- Portable storage reels
- Hose assemblies

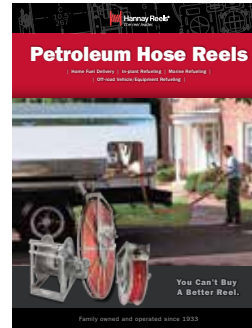

Petroleum Hose Reels

Comprehensive information on:

- Manual or power rewind reels
- Power rewind reels for inverted installation
- Single wrap power rewind reels
- Guide for inverted installation

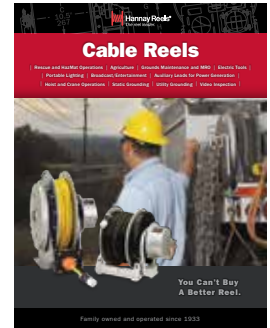

Cable Reels

Find out more about:

- Manual and power rewind reels
- Storage reels
- Reels for live electric cable
- Portable reels
- Static and truck grounding reels

View all our reel catalogs online at **hannay.com**



Family owned and operated since 1933, Hannay Reels is the world leader in both OEM and aftermarket applications. Hannay offers thousands of standard hose reel and cable reel models, as well as unmatched custom capabilities. We can easily and affordably customize a reel to meet your exact specifications – built to last, delivered fast. Additional catalogs are available through your local Hannay Reels dealer or online at **hannay.com**.



553 State Route 143 | Westerlo, New York 12193
Email: reels@hannay.com | hannay.com



All Hannay reels are constructed of quality heavy gauge steel (optional aluminum or stainless steel also available on most models).

Phone: **518-797-3791**
Toll Free: **1-877-467-3357**

Domestic FAX: **1-800-733-5464**
International FAX: **518-797-3259**

Form H-0506-LP REV 8-21